







**FIND**  
DESIGN FAIR  
ASIA



# Participation Option

<b>Booth Types</b> Shell Scheme or Raw Space	<b>Shell Scheme/SQM</b> White Wood Structure (Min 12 SQM)		<b>Raw Space/SQM</b> (Min 18 SQM)
<b>ROW</b> <b>1-Side Open</b>	<b>SGD \$700</b>		<b>SGD \$615</b>
<b>CORNER</b> <b>2-Sides Open</b>	<b>SGD \$780</b>		<b>SGD \$650</b>
<b>PENINSULA</b> <b>3-Sides Open</b>	<b>SGD \$840</b>		<b>SGD \$715</b>
<b>ISLAND</b> <b>4-Sides Open</b>	<b>SGD \$920</b>		<b>SGD \$750</b>

- Exhibitors can choose between different locations, booth types (raw space or shell scheme) and number of sides open.
- Minimum booth sizes are 12 sqm for shell scheme or 18 sqm for raw space exhibitors. Island booths require a minimum of 36 sqm.
- 9% GST applicable for Singapore registered companies only.
- 7% VAT is applicable for Thailand registered companies only.
- All exhibition contracts will have a mandatory 380 SGD fee for marketing, administration and incorporating a provision of public liability protection for exhibitors.
- White shell scheme booth is wood based, and walls are solid for display hanging.



# Booth Details

## Shell Scheme

- Minimum size: 12 sqm
- Increments: multiples of 12 sqm

## Raw Space

Wall-side areas:

- minimum size: 18 sqm with increments of 9 sqm

Central areas:

- sizing follows multiples of 12 sqm



# Floorplan

## Furniture, Interiors and Design.

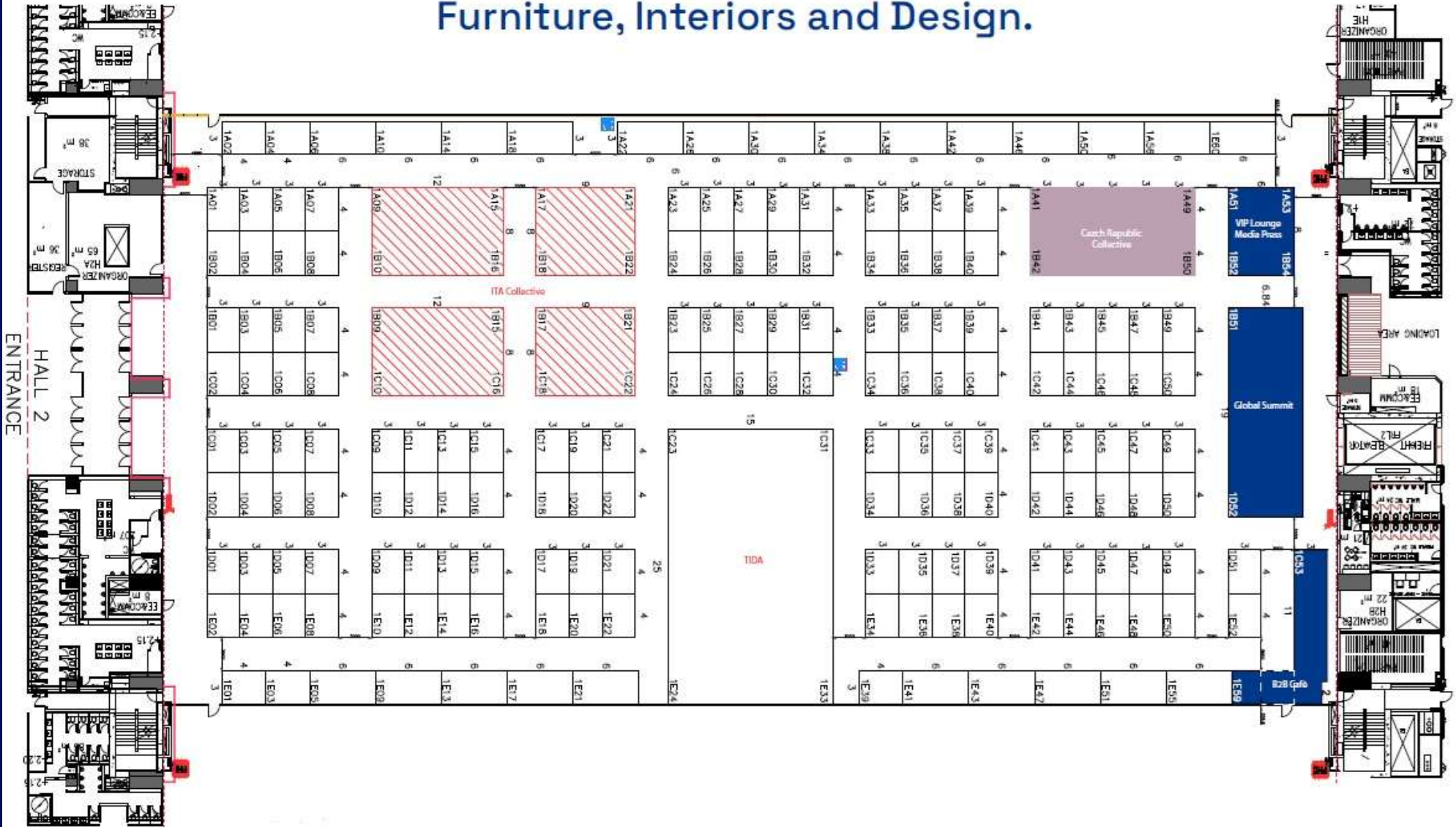



# FIND

DESIGN FAIR  
ASIA



**FIERA MILANO  
ASIA PACIFIC**

CONTACT US:

[Sales@fieramilanoaisapacific.it](mailto:Sales@fieramilanoaisapacific.it)

